

Experience **BUTLER COUNTY**

ALLISON | APLINGTON | AREDALE | BRISTOW | CLARKSVILLE | DUMONT | GREENE | NEW HARTFORD | PARKERSBURG | SHELL ROCK



LOCATION

LOCATION

LOCATION



Is an expansion or relocation in your company's future?
Location plays a key role in efficiently getting your product to market.
Butler County is in one of the Midwest's fastest growing logistics corridors.

THE ADVANTAGES...

- Access to major 4-lane highway corridor. I-380, I-35, Hwy 218 & Hwy 20
- Shovel ready Industrial Parks throughout Butler & Grundy Counties
- Locally owned railroad offering flexible connections to all U.S. markets
- Workforce training and development programs
- Labor force draw of over 200,000 in the Cedar Valley Region
- Confidential site selection assistance
- Financial assistance programs
- Small Business Financial Assistance Programs"



Jeff Kolb
Executive Director

Email: info@butlergrundy.com
Phone: (319) 267-2858

422 North Main
Allison, Iowa 50602



Welcome to *Butler* *County*

Welcome to Iowa's Outdoor Recreation Destination! Located in The Cedar Valley Region of Northeast Iowa, Butler County offers a variety of ways to experience the outdoors. From biking to kayaking, or a weekend of camping with the family. Butler County offers much more than just outdoor recreation, and new in this edition, we are highlighting a few of these destinations. Our small communities welcome you to grab a bite at one of our longtime eateries, and also to check out the new dining destinations that have opened over this past year. You will find unique shopping and local bars to sit down and make new friends. If you come to stay in one of our many campgrounds or are taking a ride on the bike trail, be sure to give yourself time to experience the nearby downtown.

After your visit is complete, I encourage you to return, and consider making Butler County your home. Continued growth with new business and industry has

created more career opportunities than ever before. Expanding fiberoptic broadband by local providers has made this a prime location for those that can work remotely. A lower cost of living, and a safe environment to raise a family round out the reasons why this is the perfect time to make Butler County your home. I encourage you to follow our social media handle @livethevalley on Facebook, Instagram, Twitter, and LinkedIn to see for yourself how we "Live the Valley". Check out www.livethevalley.com to see all that our region has to offer, plus you can use our handy "cost of living comparison tool". We are only a phone call or email away to help with planning your visit, or for relocation assistance. Feel free to contact our office at (319) 267-2858 or send an email to info@butlergrundy.com.

JEFF KOLB
Executive Director
Butler-Grundy Development Alliance





TABLE OF CONTENTS

5 Festivals and Events	20 Shell Rock River Activities	30 Trains of the Farm
6 Parks & Recreation Directory	22 Unique Destinations	32 Church Listings
8 Rolling Prairie Bike Trail	24 Swimming Pool & Splashpad Directory	36 Barn Quilts
10 New Butler County Fishing Dock	25 Heery Woods Nature Center	38 Snowmobile Trails
12 Ice Cream & Popcorn Stand Directory	28 All Play Ball Park	
13 Golf Course & Library Directory	29 Playground & Park Directory	
14 Camping Directory		
16 Historical Attractions		

**SUBSCRIBE TO YOUR
LOCAL NEWSPAPER**

ECLIPSE NEWS-REVIEW
Annual Local Rate • \$58
Annual Out of Area • \$64

**BUTLER COUNTY
STAR TRIBUNE**

Annual Local Rate • \$59
Annual Out of Area • \$66

**SHOP LOCAL. EAT LOCAL.
READ LOCAL.**

**Mid-America
PUBLISHING**
& Printing

*Divisions of Mid-America
Publishing & Printing*

2025 Butler County *Festivals & Events*

BUTLERCOUNTYIOWA.COM

FEBRUARY

February 1 Lighted Night Ski – Heery Woods Clarksville (319) 278-4237

MAY

May 2 Cinco de Mayo Food Truck Fiesta Aplington (319) 347-2425

May 2 - 3 City-Wide Garage Sales Greene (641) 426-5706

May 3 City-Wide Garage Sales Parkersburg (319) 346-1461

May 8 Ladies Night (downtown) Clarksville (319) 278-4531

May 15 - 17 City-Wide Garage Sales Clarksville (319) 278-4531

May 30 - 31 Allison Days Allison (319) 346-7630

May 30 - 31 City-Wide Garage Sales Allison (319) 346-7630

May 31 City-Wide Garage Sales Aplington (319) 347-2425

JUNE

June 2 - 3 Aplington Days Aplington (319) 347-2425

June 5 - 7 Pioneer Days Clarksville (319) 278-4531

June 13 - 14 River Days Greene (641) 816-4631

June 20-21 Beaver Creek Days New Hartford (319) 504-0269

June 21 Sandbaggin' Day & Car Show Dumont (641) 430-9613

June 21 City-Wide Garage Sales Dumont (641) 857-3411

June 25 - 29 Butler County Fair Allison (319) 267-2775

JULY

July 3 Fireworks Greene (641) 816-4631

July 3 - 6 4th of July Festival Shell Rock (319) 231-7697

July 4 Fireworks Shell Rock (319) 231-7697

July 6 Barefoot Becky Polka Concert Clarksville (319) 278-4644

July 11 Relay for Life of Butler County Allison (319) 830-4908

July 16 Wilder Park Concert Series Allison (319) 346-7630

July 23 Wilder Park Concert Series Allison (319) 346-7630

July 30 Wilder Park Concert Series Allison (319) 346-7630

July 26 At Home Aplington Tractor Ride Aplington (319) 347-2425

July 26 - 27 Bristow Days Tractor Pull & Dance Bristow (712) 790-7309

July 27 Herb Fest Greene (641) 330-0938

AUGUST

August 1-2 Fun Days Parkersburg (319) 830-6036

August 6 Wilder Park Concert Series Allison (319) 346-7630

August 13 Wilder Park Concert Series Allison (319) 346-7630

August 17 Show & Shine Car Show Parkersburg (319) 269-6242

Aug 28 - 30 Highway 3 Garages Sales 3 Counties (641) 456-5668

SEPTEMBER

September 4 - 6 City-Wide Garage Sales Clarksville (319) 278-4531

September 12 - 13 Vintage Market & Antique Show Allison (fairgrounds) (319) 240-7294

September 27 - 28 City-Wide Garage Sales Greene (641) 426-5706

OCTOBER

October 4 Harvest Moon Festival Allison (319) 346-7630

October 21 Halloween Hike – Heery Woods Clarksville (319) 346-6551

October 25 Craft Expo Clarksville (319) 278-4644

NOVEMBER

November 1 Craft Show New Hartford (319) 983-2548

November 29 Small Business Saturday Shop Local (319) 267-2858

DECEMBER

December 3 Stocking Stroll Shell Rock (319) 885-6555

December 4 & 6 Jolly Jamboree Parkersburg (319) 346-8144

December 6 - 13 Tiny Tim Festival of Trees Clarksville (319) 278-1168

Dec. 6, 13, 20 Community of Lights Display (park) Aplington (319) 347-2425

December 7 Images of Christmas Clarksville (319) 278-4531

Get outside & *Play*

LEGEND

Tent
Camping



Fishing



Winter
Recreation Area



Hiking
Trails



Trailer
Camping



Boating
Access



Bike Trail
Access



Sanitary Disposal
Station



Golf
Course



WILDER PARK
Allison, 22301 Highway 3
www.visitwilderpark.com



This large city park encompasses 78 acres with a modern RV campground. The camping area has 26 full hookup sites, 26 with electric and water and 22 full season sites. There is also a tent camping area. You will enjoy two scenic ponds for fishing and other water activities, shelter houses, playground, chapel, banquet lodge, rental cabins, miniature golf - disc golf, pickleball, and other large yard games. Facilities include restrooms and showers. Wi-Fi is also available. Bike riders have direct access to the Rolling Prairie Trail on the north end of the park that provides safe family recreation while on your camping getaway. The park also hosts weekly musical entertainment for campers and the public to enjoy free of charge. Several of the headline events are included in the calendar of events found elsewhere in this guide.

Online camping reservations are now available.

NORTHEAST IOWA CHRISTIAN SERVICE CAMP

19268 Forest Avenue • (641) 775-3238

Located one mile west of Bristow, this 30-acre scenic getaway is bordered by Boylan Creek and the Rolling Prairie Bike Trail. The park-like setting offers two seven-person cabins, a single gender dorm with an 80-person capacity and a dual gender dorm with 100-person capacity. You will also find a chapel, kitchen, dining hall, and multi-purpose building. Recreational facilities include disc golf, miniature golf, 9-Square, gaga ball, volleyball, and a water slide. Camping facilities include RV hookups, freshwater, and dump. The facility is available for private rentals from mid-August through May.

LAKE CONSIDINE

15509 230th Street, Dumont

The major use of this area is fishing and hunting. The majority of the area provides excellent hunting opportunities for deer, turkey, squirrel and duck. The West Fork River and small pond provide fishing opportunities for many different fish species. Since most of the pond is privately owned, we ask that you respect private property in this area.

CAMP COMFORT RECREATION AREA

23525 Camp Comfort Road

This 27-acre area is one of the most popular areas operated by the Conservation Board. Located south of Greene and east of Highway 14 along the Shell Rock River, this park offers excellent recreational opportunities. Fishing for walleye and smallmouth bass below the dam is excellent as is fishing for catfish above the dam. The area has boat ramps and canoe access both above and below the dam, a large shelter house, and camping facilities with electricity for 25 trailers as well as an area for tents.

SOUTH FORK PARK

South Fork Access

21045 Cedar Avenue, Dumont

South Fork Park has much to offer despite its small size. Only 20 acres in size, the area offers access to the South Fork of the West Fork River and a 3-acre lake stocked with bass, bluegill and yellow perch. In addition to its fishing resources, the area provides a small variety of upland and forest type resources for hunting. Primitive camping is allowed, but no water or toilet facilities are available.

SPORTSMAN PARK

27588 180th Street, Clarksville

Located on the west edge of Clarksville on Superior Road, this park has undergone many changes. It was the site of the cabin of the first settlers in Butler County, and it was later used to provide fill to build the railroads across the county. Today, the park provides an excellent opportunity for family enjoyment. The 6-acre lake, picnic shelter, and playground offer something for all ages.

SCHWARTZ MEMORIAL PARK

Schwartz Memorial Park is a new park on the east end of town. Located on Newell Avenue, the park has new playground equipment, gazebo, walking path, and a pond for fishing.

SHELL ROCK RECREATIONAL AREA

22562 Main Street

This 40-acre area, located on the west edge of Shell Rock off Highway 3, was one of the very first areas purchased by the Conservation Board. A playground, shelter house, flush toilets and showers are just a few of its many features. The area has 30 electrical hook-ups, and the Shell Rock River offers fishing, a canoe access, and boat ramp. A lake on the west edge of the park offers fishing for a variety of species during both the summer and winter.

BEAVER MEADOWS PARK

32078 Highway 14, Parkersburg

Tucked between Beaver Creek and Beaver Meadows Golf Course, this 32-acre area was once a state park. Today the park is managed by the Butler County Conservation Board and offers a wide variety of recreational activities. Fishing for smallmouth bass, catfish and northern pike is good in Beaver Creek, Traditional golfers can access Beaver Meadows Golf Course and disc golf players can try their skill on the 9-hole course within the park. The camping area at Beaver Meadows provides 50 amp service for up to 16 campers, flush toilets, showers, and two shelter houses. Visitors to Beaver Meadows are also within walking distance of the downtown business district.

WUNSCH MEMORIAL PARK

Rowley Street, Greene

Located just below the dam along the Shell Rock River in Greene is the 1.2 acre Wunsch Memorial Park. A popular area, this park offers electricity, running water, access to the river, and a boat ramp. It also includes 10 electrical camp sites and a new shelter house. Water above the dam is deep enough for pleasure boating. The location of this area is within easy walking distance of shops, museums, and the city park.

HEERY WOODS STATE PARK

North side: 19195 Highway 188

South side: 27887 195th Street

The park provides excellent opportunities for fishing, boating, and hiking. The camping area features electrical hook-ups for 20 trailers plus a large tent area with modern restrooms and showers. There are several picnic areas throughout the park, as well as a nature center with many hands-on exhibits located on the south side of the river near the stone lodge. The park also provides direct access to the Rolling Prairie Trail.

Straddling the Shell Rock River, Heery Woods State Park contains the original tract of land belonging to the first land owner in the county. After it became a state park in 1935, workers of the Works Progress Administration were used to develop the park. They built a dam, the original shelter house, and the stone lodge located on the south side of the river. Today the park is under the management of the Butler County Conservation Board.

ROLLING PRAIRIE BIKE TRAIL

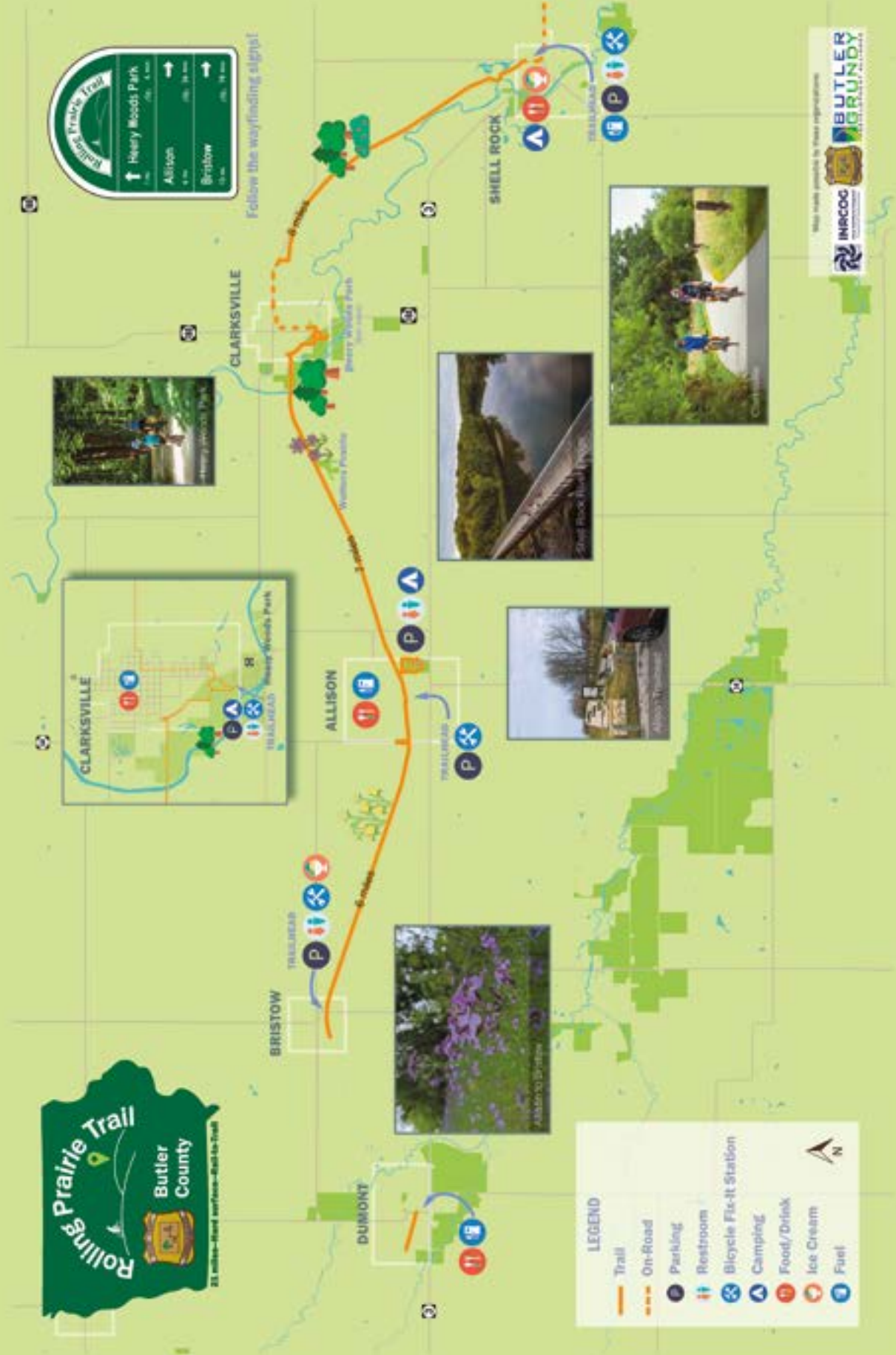

ROLLING PRAIRIE BIKE TRAIL

This 21 mile paved trail connects Clarksville, Allison, Bristow, and Shell Rock. This hard surface trail features a nice mix of natural canopy and scenic bridges.

The expansion from Allison to Bristow was completed in 2018. Each of the trailheads features a kiosk with maps, trail information, and more. In the future, plans are to expand west to Dumont, once funding is secured.

A bike repair station is available at the Volunteer City Park trailhead.

Trail Heads and Amenities

SHELL ROCK

- Trail head located 1/3 mile north of Highway 3 on T-63
- Parking available
- ATM at Kwik Star
- Kiosk with maps and information
- New bike repair station is available

CLARKSVILLE

- Trail head at Volunteer Park (one block east of Highway 188, south edge of town)
- Parking and restrooms available
- New bike repair station is available at Volunteer Park
- ATM at Casey's General Store and Iowa State Bank (downtown)
- Trail head at Heery Woods State Park – kiosk with maps and information

ALLISON

- Trail head near downtown on Elm Street one block east of Main Street – kiosk with maps and information
- Trail head at Wilder Park (park entrance on Highway 3)
- Parking and restrooms available
- ATM at Casey's General Store and Lincoln Savings Bank (downtown)
- New bike repair station is available

BRISTOW

- Trail head located in southeast area of town on Grand Avenue
- Parking and restrooms available at city park, two blocks southwest of trail head
- Ice Cream Stand located in city park. Open daily 4 p.m. to 8 p.m.
- New bike repair station is available



All Access

New Butler County fishing dock provides access to those with limited mobility



CLARKSVILLE — A 2023 Butler County project has made fishing more accessible to those with limited mobility.

Last year the Butler County Conservation Board used grant funds to purchase and install an accessible fishing pier at Heery Woods on the Shell Rock River.

"I'm told it's one of the better fishing spots," Naturist Annette Wittrock said.

The pier is located near the park's campground and just below the dam.

"Before it was even done, there were people down there fishing on it because that's where they like to fish," Wittrock

said. "They were fishing while we were pouring concrete at that fishing pier."

In addition to the pier, the Conservation Board also built a small ramp so that visitors could launch their canoes and kayaks at the location. They also put a fully accessible dock at Sportsman Park in Clarksville with an accessible canoe and kayak launch.

"It's got a bench and straps and things like that that go out over the boat," Wittrock said. "So if you can't walk very well, or anything like that, or if you're in a wheelchair, you can get yourself out to your boat, using that bench."

Wittrock said making fishing and other uses of the waterways easier for people of all abilities is simply a matter of serving the community.

"We want to make it as easy as possible," she said. "I know, other conservation boards and the (Department of Natural Resources) have done these projects. They're not cheap, and that's usually the hindrance in doing that, so we do it as the money is available. I think a lot of people and a lot of conservation areas are trying to do that."





NEW ADVENTURES. AUTHENTIC COWS. COMFY BEDS.

Book @ newdaydairy.com

#sleepwiththecows

with 24/7 cow gazing on a modern dairy farm
private 3 bed/3 bath vacation rental



A-P Appliance

Heating & Cooling

AMANA
KitchenAid

Whirlpool

MAYTAG

FRIGIDAIRE
It's Hard To Stop A Flow!

901 Lincoln St, Parkersburg
319.346.2747

WELCOME TO BUTLER COUNTY!

Video Banking and 24/7
ATM service available
at these First Security
locations!



FIRST SECURITY
1stsecurity.bank Member FDIC



Welcome Home!

At Abbott Realty in Hampton, Iowa our primary mission is to provide a level of customer service that exceeds expectations.

Quality long-term relationships are the foundation of our business. At the close of your first transaction with Abbott Realty, you should feel free as if you've tapped into a real estate resource that will serve you well for years to come.

We pride ourselves on our listening skills, attention to detail, ethical conduct and professional discretion.

We look forward to earning your trust and your business.



KELSEY STANBROUGH
SALES ASSOCIATE
641-812-0739



KATHY PLENDL
BROKER/OWNER
641-430-3821



CHUCK SVENDSEN
SALES ASSOCIATE
641-425-7159

641-456-4707

7 First Avenue NE, HAMPTON, IA 50441
www.hamptoniowarealestate.com



Fiber Internet, Digital TV & Phone



715 Main Street, PO Box 99
Plainfield, IA 50666
319.276.4458
www.butler-bremer.com



521 N. Main St., Allison, IA 50602
319-267-2726 • www.butlerrec.com



LET THE GOOD TIMES BOWL!

6 Lane center offering open bowling and leagues.
Book your next birthday party, class / family reunion or holiday party with us.

FREEZE FRAME BOWL

3064 Hwy 14, Greene, IA • 641-916-BOWL (2695)

freezeframebowl.com Facebook: Freeze Frame Bowl



Home of the
"Tuscan Sirloin"

Grab a Snack



APLINGTON POPCORN STAND

CLARKSVILLE POPCORN STAND **101 South Main Street, Clarksville**

A tradition for over 50 years, the popcorn stand has welcomed generations to downtown on weekend evenings. The popcorn stand is open Saturday and Sunday evenings from Memorial Day through Labor Day from 6 – 8:30 p.m. The stand is operated by volunteers, with proceeds going to community projects. Follow the popcorn stand on Facebook for undated information.

DUMONT POPCORN STAND **Main Street, Downtown Dumont**

Open May through August. Hours are Wednesday and Saturday 6:30 – 9 p.m.

APLINGTON POPCORN STAND **NEED ADDRESS FOR THIS**

A recent addition to downtown Aplington, the popcorn stand is operated by community volunteers every Sunday evening from 6PM to 8PM

BRISTOW ICE CREAM SHACK **716 West Street, Bristow** **Open daily 10 a.m. to 8 p.m. during summer**

A popular destination for riders on the Rolling Prairie Bike trail, the Ice Cream Shack is a community endeavor, and offers soft serve ice cream cones, shakes, blenders, and other cool treats for a summer break. The Ice Cream Shack is located in the City Park adjacent to the splashpad, and is open daily 4PM to 8PM during the summer.



BRISTOW ICE CREAM SHACK

PARKERSBURG GOLF COURSES

Beaver Meadows Golf and C.C. (9 holes)

Highway 14 North • (319) 346-1870

Legend Trail Golf Course (9 holes)

Highway 57 East • (319) 346-1499

CLARKSVILLE GOLF COURSE

C.A.R.D. Country Club: (9 holes)

Highway 188 South, Clarksville

(319) 278-4787

APLINGTON GOLF COURSE

Aplington Recreation Complex (9 holes)

1311 Parriott Street, Aplington

(319) 347-6059

GREENE GOLF COURSE

Round Grove Country Club (9 holes)

20498 Floyd Line Street

(641) 816-5621



GREENE GOLF COURSE



ALLISON LIBRARY

412 3rd Street, Allison • (319) 267-2562

www.allison.lib.ia.us

APLINGTON LEGION MEMORIAL LIBRARY

929 Parriott Street, Aplington • (319) 347-2432

www.aplington.lib.ia.us

BENNY GAMBAIANI PUBLIC LIBRARY

104 North Cherry Street, Shell Rock • (319) 885-4345

www.shellrocklibrary.org

DUMONT COMMUNITY LIBRARY

602 Second Street, Dumont • (641) 857-3304

www.dumont.lib.ia.us

ELIZABETH RASMUSSEN MARTIN MEMORIAL LIBRARY

406 Packwaukee Street, New Hartford • (319) 983-2533

KOTHE MEMORIAL LIBRARY

309 Third Street, Parkersburg • (319) 346-2442

GREENE PULIC LIBRARY

231 West Traer, Greene • (641) 816-5642

www.greene.lib.ia.us

CLARKSVILLE PUBLIC LIBRARY

103 West Greene Street, Clarksville

Phone & Fax (319) 278-1168

clarksvillelib@butler-bremer.com



Life is better when you're *Camping*

You will find six campgrounds spread across the county offering a wide variety of settings and amenities. From wooded shady campgrounds along the river, to an RV park setting, you will find a campground that your family will enjoy. Wilder Park is a city owned park, while all of the other campgrounds are managed by the Butler County Conservation Board. All of the locations are well maintained, with improvements made on a regular basis. Two of the campgrounds, Wilder Park and Heery Woods State Park, are located adjacent to the Rolling Prairie Bike Trail. Families love this, so you can ride the trail right from your campsite! Several campgrounds are also adjacent to the Shell Rock River, for fishing and water activities.

**WILDER PARK****Allison (Highway 3 east edge)**

26 Full service sites • 28 Electrical and water

For reservations, call (319) 267-2245

Online reservations at www.visitwilderpark.com

Rates for 2025: Regular sites with electric - \$24.00 per night

Full Service (electric plus water and sewer) - \$28.00 per night,

Tent sites - \$16.00 per night.

WUNSCH MEMORIAL AREA**Greene (Along river near city center)**

10 Electrical sites • 5 Non-electrical

BEAVER MEADOWS PARK**Parkersburg (Highway 14 north edge)**

16 Electrical sites • 10 Non-electrical

HEERY WOODS STATE PARK
Clarksville (Highway 188 south edge)

20 Electrical sites • 15 Non-electrical

SHELL ROCK PARK
Shell Rock (Highway 3 west edge)

27 Electrical sites • 15 Non-electrical

CAMP COMFORT**Greene (Four miles southeast off Highway 14)**

25 Electrical sites • 15 Non-electrical

Butler County Conservation Board Campgrounds

Beaver Meadows, Camp Comfort, Heery Woods State Park, Shell Rock Park, and Wunsch Memorial Area.

New online reservation system coming soon.

Rates for 2025: All sites, including tents, are \$15.00 per night, or \$90.00 per week

For information, call [\(319\) 346-6551](tel:3193466551)

Lodging

**ALLISON**

Emerald Door Inn Motel
(319) 267-2657

**CLARKSVILLE**

**New Day Dairy's
GuestBarn**
(319) 278-4455

**PARKERSBURG**

Legend Trail Inn & Suites
(319) 346-9788

**SHELL ROCK**

Pal's Old Mill Bed & Bath
(319) 885-6213



Historical Attractions

PARKERSBURG HISTORICAL HOME

ALL VETERANS MONUMENT

Allison, 520 North Main Street

Their Duty was to Serve. Our Duty is to Remember.

The All Veterans Monument is a tribute to all Veterans, no matter where they call home. Family and friends of veterans have honored a past or present member of the military with their name and branch of service on the pentagonal obelisk in the center of the monument field. A fallen service member who died while serving is honored with a star beside their name. The monument currently has over 800 engraved names.

An application for adding a veteran's name may be obtained from the Allison City Hall for an engraving fee of \$100. The following parameters have been set to use as a guide line to have a named engraved on the monument. You must have served, or are currently serving in the military as active military personnel. National Guard or Reserves are eligible.

APLINGTON HISTORICAL SOCIETY

**905 Parriott Street, Aplington
(319) 347-2799**

This relatively new organization strives to preserve the rich heritage of Aplington, and the surrounding area. Started in 2006, this non-profit organization houses their collection of artifacts and memorabilia in the only building in the community to survive a devastating fire in 1901. The organization's collection includes historical pieces from the former Aplington School, advertising items from past businesses, records from past and present civic groups and churches, and more to keep the heritage of the community preserved for future generations. The historical society also houses the records of the former DeBuhr Maternity Home that was located in Aplington. The organization meets monthly, while the facility is open by appointment only or during special events.

BUTLER COUNTY HALL OF FAME

Allison, Courthouse Square

The Hall of Fame is housed in a structure that is topped off with the old cupola that was removed from the Butler County Courthouse that was built in 1881, and torn down in 1975. The dome is 18 feet in diameter, 30 feet tall, and weighs approximately 7,000 pounds. Inside, you will find photos of county residents who have been inducted into the hall of fame over the years. Also on display are military artifacts dating back to the War of 1812 that were donated by county residents and their families who served in the military. Visitors are welcome. Appointments are required by calling (319) 885-6279.

AUSTINVILLE HISTORICAL SOCIETY

13376 320th Street, Austinville

The society is located in the old Austinville Bank which was founded in 1911 through the leadership of Samuel L. Patterson with Walter G. Austin and Richard C. Bode. The bank building was built around 1916. This bank building has a unique history, and is referred to as "the most robbed bank in Iowa", enduring many robberies and attempted robberies before it closed. This is the one remaining structure of the original main street businesses from that time. It was one of the few banks that stayed open during the depression. Displays consist of early Austinville items from the local businesses. There is also an extensive inventory of histories, pictures, and written items to be read or viewed at the historical society.

There is usually a gathering of locals for coffee each Tuesday from 9-10 a.m. for reminiscing and current local news. Feel free to drop by for coffee and conversation.

Other times to view items are by appointment. Call any of the Historical Society board members. Board member numbers are posted in the entry to the building. Call Carolyn DeVries at (319) 347-2983 to set up a time to view items.

BUTLER COUNTY MUSEUM

Allison, Butler County Fairgrounds

The museum contains numerous exhibits ranging from children's toys, medical equipment, hand tools, and a wedding gown and suit worn by a couple that was married at the county fair in 1935. Other artifacts include the first folding ironing board, various farming tools and equipment, and various artifacts relating to life in Butler County in years past. The Butler County Museum is open during the fair, and also by appointment. Call (319) 885-6279 for more information.



CLARKSVILLE HISTORY MUSEUM

103 West Greene Street, Clarksville

Visit the Mark Pulis History Room, named after the 1932 Clarksville alumnus. The room is full of Clarksville historical artifacts, memorabilia, CHS class pictures, a schoolroom, and items from Clarksville businesses and organizations past and present. Located in the (handicapped accessible) lower level of the Clarksville Public Library, the room is open to the public during the Library's regular business hours: Monday and Wednesday 10 a.m. to 6 p.m.; Tuesday and Thursday 10 a.m. to 5 p.m.; Friday 10 a.m. to 4 p.m.; and Saturday 10 a.m. to 2 p.m.

DUMONT AREA VETERANS MEMORIAL

Downtown Dumont

New in 2025, the Veterans Memorial is a park-like setting utilizing stone in downtown Dumont. The memorial was developed by the American Legion Post 360, and honors approximately one thousand veterans from the area who served our country from the Civil War to present day. You will also find an educational component which explains each branch of service and emphasizing the fact that "Our freedom is Not free". Seating is available for quiet reflection. A dedication is planned for Memorial Day of this year.

LITTLE YELLOW SCHOOLHOUSE

Allison, Courthouse Square

Built in 1888, this one room schoolhouse served the educational needs of section three in Pittsford Township near the town of Aredale until 1957. The building was relocated to the courthouse square in Allison, and was the first attraction of the Butler County Historical Society. Volunteer retired school teachers help educate current school children from around the county on what it would have been like to get their education in a one room school. The school is outfitted with sleigh desks and other props from the era when it was used. Visitors are welcome. Appointments are required by calling (319) 885-6279.

PARKERSBURG HISTORICAL HOME

401 Fifth Street, Parkersburg

This Victorian home was built in 1895. Visitors will enjoy the wide variety of woodwork in each room, as well as many artifacts of local history. The home features a circular tower that provides a panoramic view of the surrounding area. Open Sunday afternoons from 1 – 3 p.m. from Memorial Day through Labor Day, and by appointment.

Call (319) 231-0079 for information.

SHELL ROCK HISTORICAL MUSEUM

127 East Adair Street, Shell Rock

Visit this 1920s Craftsman style house that is home to a large display of memorabilia from Shell Rock's history. There is an original garage on site, which is unusual for this style of house. A railroad room and a school room are part of the permanent exhibits. Visitors can also view rotating exhibits throughout the year. Open Saturdays from 10 a.m. to 2 p.m., and other times by appointment. Call (319) 885-6687.

LITTLE YELLOW SCHOOLHOUSE



ALL VETERANS MONUMENT

Here to serve you....

- Broadband
- Telephone
- Cable TV
- Business Systems
- Network Wiring
- WiFi Routers

506 Pine Street
P.O. Box 349
Dumont, IA 50625-0349
www.dumonttelephone.com
641-857-3211



A Loving Tribute

...to one who
is gone, but
who will never
be forgotten



**LUHRING
MONUMENTS**

Quality that lasts. Since 1983.

504 Hwy. 57, Parkersburg, IA
319-346-1445
luhringmonuments.com



A vertical advertisement for NAPA Auto Parts. At the top is the NAPA logo (a yellow hexagon with 'NAPA' in blue). Below it, 'AUTO PARTS' is written in large, bold, yellow letters with a red underline. Underneath, 'TRUSTED PARTS & SERVICE' is written in white, bold, sans-serif font. A yellow horizontal band contains the text '...YESTERDAY, TODAY AND TOMORROW' in white, bold, sans-serif font. The bottom section is blue with white text: 'Monday-Friday 8-5, Saturday 8-12', '202 4th Street • Parkersburg, IA 50665', '(319) 346-2103', and 'Chad and Nikki Oldenburger, Owners'.



Boat or
float on the

Shell Rock River



BUTLER COUNTY — By far the largest tourist attraction in Butler County is the Shell Rock River.

Entering Butler County at its northwest corner, the river flows southeast, passing through Greene, Clarksville and Shell Rock before entering Black Hawk County and emptying into the Cedar River. The river provides endless opportunity for fishing and boating as well as the chance to see wildlife.

Boat and kayak access to the river is available at both Perrin City Park and Wunsch Memorial Park in Greene, the Camp Comfort Recreation Area between Greene and Clarksville, Heery Woods State Park in Clarksville, Renning's Landing between Clarksville and Shell Rock and at three locations in Shell Rock.

Parks listed above also provide the best fishing access along the river, with dams located in Greene, Clarksville and Shell Rock. According to the Iowa Department of Natural Resources, popular fish species include channel catfish, muskies, northern pike, smallmouth bass and walleye. Walleye are the only fish stocked in the Shell Rock River by the DNR.

A stretch of the river near Greene also offers opportunities for skiing and pontooning, with a nearly seven-mile stretch of unimpeded waterway.

Parks along the river offer modern amenities including camping with electric hookups, modern restrooms, playgrounds and walking/ biking trails. See the camping directory and conservation maps elsewhere in this guide for more information.



Boat and Kayak access available at:

1. a. Perrin City Park
b. Wunsch Memorial Park
2. Camp Comfort Recreation Area
3. Heery Woods State Park
(north side, south side off Timber Road)
4. Renning's Landing
5. a. Shell Rock Recreational Area
b. Dam - North side of river
c. Below dam in Shell Rock on East Water Street

Kayak float times vary, please call **(319) 346-6551** for river level and more information.



Uniquely Fun *Destinations*



ALLAN AND FAYETTE MEYER NATURE CENTER

27887 195th Street, Clarksville

The nature center is the hub of the Butler County Conservation Board, where visitors can find exhibits and displays about local flora and fauna, the parks history, and live animals from the area. The Butler CCB offers year round environmental education for schools, youth, special interest groups, and the public. You can schedule a presentation for your group by calling 319-346-6551 or e-mailing butlernaturalist@butler-bremer.com. All public events, park information, and updates will be advertised on the Butler County Conservation Board Facebook page, mycountyparks.com, in local newspapers and on local radio stations. If you would like to have information sent directly to you electronically, use the e-mail above to sign up for the newsletter.

LITTLE VALLEY CHURCH

518 Early Street, Bristow

Said to be the smallest church in Iowa, measuring in at six feet by eight feet and ten feet tall, not including the steeple. Inside you will find four small pews to seat four adults, an altar, and yes, room to stand up! Constructed in 1972, it was originally located in Allison. The small church has hosted visitors from over 40 states. Owner Sally Schneiderman loves to have visitors to the church and adjacent flower gardens. Open by request only. Please call (319) 429-6536 for information.

THE CITY OF GARDENS

The City of New Hartford has ten amazing parks and newly created public gardens. The Heritage Garden offers a glimpse into the past. The Four Seasons Perennial Garden is a great place to just relax and enjoy nature. The Fruit Tree Orchard was created after winning a nationwide contest sponsored by Edy's Fruit Bars and the Fruit Trees Planting Foundation. Designed by one of our own, the Veteran's Memorial Garden speaks for itself. This garden is a breathtaking salute to our country's heroes. The Community Gardens allow those yummy vegetables to be grown. The Town Square Gazebo Garden is a stunning place to hold a variety of events. It is especially beautiful for weddings. The Meditation Garden is designed to reflect on the past, present and future. It honors those lives lost in Butler County during the 2008 deadly EF5 tornado. The newest park is the Log Cabin Learning Center. This design is in remembrance of Joe Dennis' legacy. He would sit on his log cabin porch for hours playing his guitar, bringing in listeners of all ages. This new addition offers a meeting room, including restroom amenities and an outside fire pit surrounded by swings. The Family Park is another great place where horse play is encouraged. Packwaukee Park hosts a continuous stream of all ages showing off their volleyball, basketball, softball and baseball talents. It also accommodates the community events. Self-guided tour maps are available at each garden and outside City Hall. Private tours can also be arranged. All gardens and facilities are handicapped accessible, and restrooms are available. For more information call (319) 983-2548.



FREEDOM ROCK



NEW DAY DAIRY GUESTBARN

NEW DAY DAIRY GUESTBARN

31000 175th Street, Clarksville • (319) 278-4455

www.newdaydairy.com

Find New Adventures, Authentic Cows, and Comfy Beds at when you #sleepwiththecows at Iowa's only FarmStay on a working dairy farm! 24/7 access to two large loft windows looking directly into the Bolin family's barn. Cow gaze at the 120 milking cows enjoying life and then meet them up close on an Intro & Farewell Tour. Meet Rita the robot who milks the cows and pet a baby calf! As a vacation rental property (with three bedrooms & bathrooms), you'll be the only ones sleeping with the cows.

For a more hands-on tour try the "Be A Dairy Farmer" Challenge - you'll ride in the tractor, bottle feed calves, milk a cow by hand, get in among the cows to scrape manure, and peek under Rita's hood. Take an exclusive t-shirt home to prove you can be a dairy farmer!

Just passing through? Small group tours are available to non-guests. Check our website for more info & to book your night with the cows! Winner of Travel Iowa's 2022 Outstanding Rural Lodging Award"

TRAINS ON THE FARM RAILROAD TOURS

30215 170th Street, Clarksville

Personal guided tours of several railroad sites throughout the area, including the operational Iowa Northern Railway. Go behind the scenes and view railroad yards, engine, caboose, and more. Plus see the Rock Island museum, layouts, and displays all on a farm!

By appointment only. (319) 278-4847

www.trainsonthefarm.com

NEW HARTFORD MOTORCYCLE RACING

County Road T-55, north of New Hartford

Flat track and MX motorcycle racing facility. Holds regular racing events throughout the summer months with camping area available. Call (319) 885-NHMX (6469) for information or visit www.newhartfordracing.com

BUTLER COUNTY FREEDOM ROCK

102 West Traer Street

Painted in 2016 by Ray "Bubba" Sorensen. The Iowa Freedom Rock tour was started to spread the message of thanking our Veterans while providing a unique tourism attraction in all of Iowa's 99 counties. The rock is located in a small park-like setting, adjacent to the Shell Rock River, in downtown Greene.

FREEZE FRAME BOWL

3064 Highway 14, Greene • (641) 816-2695

Modern six lane community bowling center that offers men's, women's, mixed leagues, open bowling, and cosmic bowling. You will also find a full service restaurant plus arcade games and billiards. Please visit their website for more information and hours. www.freezeframebowl.com



ALLAN AND FAYETTE MEYER NATURE CENTER

in the Swim of things



SHELL ROCK AQUATIC CENTER

ALLISON SWIMMING POOL

920 Fourth Street • (319) 267-2762

GREENE SWIMMING POOL

Aquatic Center • 205 West Rowley Street • (641) 816-3020

PARKERSBURG SWIMMING POOL

110 Colfax Street, Parkersburg • (319) 346-2547

BRISTOW SPLASHPAD

Address to come

CLARKSVILLE SPLASHPAD

1103 S Main St, Clarksville, IA 50619

NEW HARTFORD SPLASHPAD

302 Water St, New Hartford, IA 50660

SHELL ROCK AQUATIC CENTER

614 E Jackson Street • (319) 885-6400



SMC INSURANCE
A First MainStreet Agency

641-857-3413 • 600 Main St., Dumont • shelly@smcinsuranceagency.com

FACIALS MASSAGE WAXING SPRAY TANS LASH & BROW MAKEUP

203 3RD ST.
PARKERSBURG, IA



319.939.3509
WWW.MELTTHERAPEUTIC.COM

Therapeutic Massage & Skincare

New Exhibits Coming to Expanded Heery Woods Nature Center

CLARKSVILLE — 2025 looks to be a big year for the Allan and Fayette Meyer Nature Center located at Heery Woods State Park, with a pair of new displays on tap.

Naturist Annette Wittrock said the indoor displays will feature a prairie area as well as a tree with eagle's nest that will be appropriate for children the climb on.

Both displays will help fill exhibit space at the Nature Center, which expanded in 2021 with additional classroom and exhibit space. They are part of an approximately \$500,000 plan for the exhibit area.

Wittrock said the eagle tree will feature several platforms that children can climb and sit on. At the top will be a platform decorated to look like an eagle's nest.

"And we'll have some kids' stuff up there," she said.

The prairie display will show the history of the prairie in and around Butler County and how it has changed since the area was settled by Europeans.

"We'll have some taxidermy animals in there," Wittrock said. "There'll be a place where you can pull up and see what's living under the prairie. We'll have a big bison that we've got a mounted head for and that is going to have its body painted into the background so it'll look like there's bison sitting in the prairie."

"We're trying to gear our displays toward what we have here for habitat," she said.

Other work planned for the exhibit area, which will be built as funding becomes available, includes another addition to the prairie display, this time featuring farmed prairie. There will be a fallen tree

that children will be able to climb through into a water area with a beaver den. There will also be a large fish tank as well as a trapper's cabin with furs and skulls that are both currently found in the area or that have been there in the past.

Those areas will add to a sand display that is already in place. Living space for live animals that are currently on display will also get an upgrade.

Wittrock said she joined Butler County Conservation when plans for the expanded Nature Center were well underway.

"I was told that my job was to fill the building," she said. "I had ideas of what I would like to see and then we found McCullough Creative, out of Dubuque. They have worked with a lot of nature centers and put those ideas that we had into a more tangible form — something we could

see. So now we've got a book of all of our plans that we can use in our planning and our fundraising."

Wittrock said watching her ideas come to life as renderings has been fun. And to see it come to life in the form of a display will be another step altogether.

"I think once these first couple displays get in, it's going to be great because we had a lot of community members that gave to the expansion project, and they're patiently waiting for the building to be full," she said. "So the building is here and now they're ready for it to be filled up with educational displays."

The Allan and Fayette Meyer Nature Center is open weekdays from 7 a.m. to 3:30 p.m. Additional hours are available for special events.

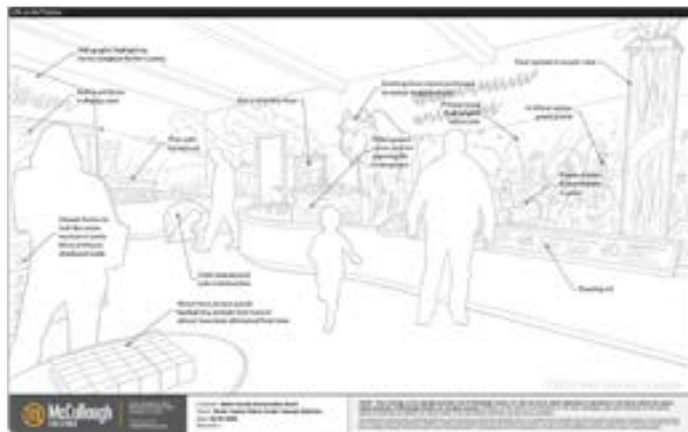
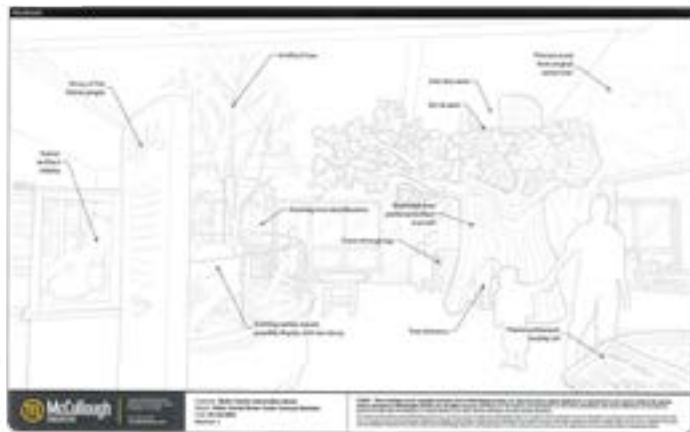



Into the *Wild*

HAUSER'S WILDLIFE AREA

11611 Vail Avenue, northeast corner of county

Diversity is one word that describes this 25-acre refuge. Located along a small tributary of the Shell Rock River called Beaver Creek, this wildlife refuge provides a combination of aquatic, forest, and upland habitats that support a wide variety of species.

WOLTER'S PRAIRIE PRESERVE

19155 Quail Avenue, Clarksville

In 1984, captivated by the beautiful wildflowers found there, the Butler County Conservation Board purchased the first half of this 40-acre native prairie area from John Wolters. In 1990 the local chapter of Pheasants Forever purchased the remaining 20 acres on behalf of the Conservation Board. The result is a well preserved island of native grasses and forbs that represent Iowa's past. Today this native prairie is used to teach about the natural and cultural history of Iowa.

HOGENCAMP WILDLIFE AREA

Highway 3, Clarksville

This newly acquired wildlife space is a 39-acre public hunting area located between Union and Terrace Avenues on the north side of Highway 3. With dry upland areas, cattail-rich wetlands, and a small pond, the Hogencamp Wildlife Area is diverse enough to provide critical habitat for both game and non-game species throughout the year. The area was purchased in 2017 by the Butler County Conservation Board using a State Habitat Stamp Grant and donations from Pheasants Forever chapters in Butler, Bremer, Black Hawk, Chickasaw, Grundy, Floyd, and Franklin Counties, and from the State Pheasants Forever organization.

MOORE'S ACCESS

29988 Trapper Road

Designed in 1997 as a walk in area only, Moore's Access provides access to Beaver Creek. A small open area located along the creek and walk in access make the area a good choice for beginning a backpacking trip. The stream allows good early-season waterfowl hunting as well as fishing for small mouth bass and catfish.



BOYLAN CREEK WILDLIFE MANAGEMENT AREA

15404 Highway 3

Purchased using Habitat Stamp Money and with help from the local Pheasants Forever and Ducks Unlimited Chapters, this 369 acre area is located just south of Bristow on Highway 3. This area features excellent hunting for upland game birds, wild turkey and white tailed deer. For the trapper, the creek, timber edges, and fence lines provide excellent runways for many furbearers. The Boylan Creek Wildlife Management Area has been enhanced with food plots, tree and shrub plantings, and nesting areas for wildlife. These enhancements provide for the needs of wildlife throughout the year.

FABER MEMORIAL WILDLIFE AREA

24260 Forest Avenue, Dumont

Donated by former board member Herman Faber, this twenty-eight acre wildlife refuge provides wildlife habitat for a variety of game and non-game species. Enhancements to the area include a replanted prairie, wetland, and wildlife food plots.

LEEPER'S PRAIRIE PRESERVE

21657 Ridge Avenue, Clarksville

Donated to the county by Doris Leeper in memory of her late husband, this 41-acre prairie area is a remnant of what once covered most of Iowa. Management of the area is limited to tree removal and periodic spring burning. These practices will help to ensure that the many prairie plants found there will continue to thrive and endure.

NORTH BUTLER WILDLIFE AREA

The North Butler Wilderness Area is located north of Dumont on the southeast corner of T16 and C33. The original 150-acre area was purchased by the local Pheasants Forever Chapters with a grant from the Iowa Habitat Stamp program, and in 2014 an additional 76 acres were added with grants and the help of the Iowa Natural Heritage Foundation. The area is enrolled in the Wetland Reserve Program and is mostly grassland with a small amount of timber. The West Fork River runs through the southwest side of the property. This combination of habitats provides hunters with opportunities for upland game, deer, and early season duck.

KYLE WILDLIFE AREA

13286 13th Street, Aredale

Donated by Joe Kyle as a wildlife refuge, this 79-acre area provides an excellent winter habitat for a wide array of wildlife including pheasants, deer, and songbirds.

EISENTRAGER WILDLIFE AREA

Acquired in 2021, the Eisentrager Wildlife Area is located approximately 2 miles south of Dumont – northwest of the intersection of Douglas Avenue and 240th Street. A part of the Cedar River Watershed, the 116 acres of land contains a sedge meadow, remnant wetlands, and upland grassland. The property is open for public hunting and provides habitat for a variety of wildlife species, including game and non-game species. Species observed on the property include: Ring-necked Pheasant, Eastern Cottontail, Red Fox, Coyotes, Canadian Geese, Teal, Mallard, River Otters, Wild Turkey, White-tailed deer, and other furbearers. The Butler County Conservation Board used a REAP Grant and donations from Pheasants Forever Chapters of Butler, North Butler, Floyd, Franklin, Bremer, Mitchell, and Cerro Gordo Counties to acquire the property.

SCHOEMAN NATURE AREA

29752 Highway 57

Schoeman Nature Area is a wetland/upland complex, which includes a variety of cool season grasses and wetland vegetation. The area boasts two shallow ponds and a wetland with mowed hiking trails throughout. Habitat improvements have included establishment of prairie, oak savanna and wildlife food plots. You will also find an approximately 300 foot raised boardwalk to get you above the wetland for wildlife viewing.



HELT MEMORIAL PRESERVE

32817 Spring Avenue, New Hartford

This 25-acre area was donated to the Conservation Board by the estate of the late Donald Helt. Placed in the CRP program in the 1980s, the area was primarily brome and timothy with a few cedar trees planted along one area. Since its acquisition, it has been enhanced with prairie grasses, a food plot, and tree plantings. These improvements have greatly increased the types and numbers of wildlife species using the area.

RENNING'S LANDING

Renning's Landing is a two-acre river access point between Clarksville and Shell Rock. The site is located on 205th Street, between Union and Utica Avenues. Acquired in 2003, the area features fishing access within the park and a concrete boat ramp that will allow users to launch small boats, canoes, and kayaks.



THE BIG MARSH WILDLIFE AREA

The Big Marsh is Iowa's largest marsh area, located six miles north of town boasting over 3,000 acres for public hunting, fishing, bird watching and hiking. The Big Marsh is a hunter's paradise during hunting season. It is located along Highway 14 north of Parkersburg.

SHELL ROCK WILDLIFE AREA

22562 Main Street, Shell Rock

Adjacent to the Shell Rock Recreation area is the Shell Rock Wildlife Area. This 49-acre area of floodplain forest provides valuable wetlands that are home to waterfowl, beaver, deer, and a variety of non-game wildlife.

WEST FORK FOREST ACCESS

28376 Temple Avenue

Between Shell Rock and New Hartford

The West Fork Forest Access is a 204 acre area that provides excellent habitat for a variety of wildlife species. Open to public hunting, the area is located on both the north and south sides of the West Fork of the Cedar River and is dotted with potholes that provide opportunities for early season waterfowl hunting. Good stands of swamp white oak trees and plantings for pines and cedars provide food and cover for squirrels, deer and wild turkey. Access to the north side of the area is found on Temple Avenue while a parking area allowing access to the south side is located on County Road C-55.

Parkersburg

Home to one of state's most inclusive ballparks

PARKERSBURG – One of Iowa's most unique and inclusive baseball parks sits on the southern edge of Butler County in the City of Parkersburg.

The All-Play Ballpark was the vision of a group of people hoping to make something good as the community was recovering from a 2008 tornado that destroyed much of the south side of the community.

Matt Waller, who along with Dave Cleary, Dan Bruns, Klay Hoppenworth and Tara Miller formed the committee that raised the \$2.5 million that it took to build the complex, said in an interview last summer that the idea for an inclusive field came as they were considering upgrading the community's older ballfields.

"The complex here was one that probably needed some upgrading, it was 30 or 40 years old at the time and we didn't have many resources in town, post-tornado, to put towards something like a youth sports complex," he said. "I had the idea of a Miracle League type of field. I'd seen one before and knew a little bit about them and I knew we could put one here in Parkersburg and that it would draw people from throughout the Cedar Valley."

When it opened in 2018, the field was the only one of its kind in the Cedar Valley. Waverly has since built a similar field and the two co-host the Cedar Valley Miracle League, which allows children with special needs to play on a field suited to their abilities.

In addition to the Miracle League park, All-Play Ballpark also features three little league baseball diamonds, a senior league diamond and three youth soccer fields. It is home to Parkersburg's youth soccer teams, which are members of the Cedar Valley Youth Soccer Association, as well as the Parkersburg Little League and the Aplington-Parkersburg School District's middle school baseball team.

"I would say the most rewarding thing is to go up there on a Wednesday or Thursday in the middle of the summer and there's no parking available," Waller said of the complex. "Every single field is filled with kids playing America's pastime."



ALL-PLAY BALL PARK

1005 Florence Street, Parkersburg

The Cedar Valley's first all-inclusive sports complex where youth of all abilities participate side-by-side as they develop and grow. The crown jewel of the Parkersburg Complex is the Miracle League field, an all-weather surface diamond that serves multiple purposes. Most importantly, it is the home of the Miracle League of Cedar Valley. The complex also includes 3 soccer fields for different age groups, 3 regulation little league diamonds, and 1 regulation senior league baseball diamond.

SKATE PARK

6th Street and Caldwell Street

The only skate park in Butler County can be found in Aplington. This popular facility is the perfect place for people of all ages to perfect and share their skateboarding skills in a controlled environment.

The park boasts a variety of obstacles including ramps, rails, and a fun box that cater to a variety of skill levels. The skate park is located in the city park where restrooms and seating are available. The skate park is not lighted, and is open during park hours until 11 p.m.

PICKLEBALL COURTS

110 Colfax Street, Parkersburg

New to Parkersburg are brand new pickleball courts. There are four courts which are free and open to the public. If you have never played, Pickleball is a paddleball sport (similar to a racquet sport) that combines elements of badminton, table tennis, and tennis. It truly is fun for the whole family, and is becoming a very popular activity.

APLINGTON CITY PARK

Sixth Street and Caldwell Street

This centrally located community gathering spot is the perfect place to relax in the shade or enjoy a family picnic or reunion. You will find an enclosed shelter house with ADA seating, an open shelter house, playground, an elevated performance stage, and restrooms. The park offers plenty of shade, and is only a short walk from the downtown business district.

MIRACLE PARK

102 Colfax Street, Parkersburg

Located on the west side of town, Miracle Park is a premier outdoor recreational attraction. It encompasses two expansive and separate playground areas, one for younger children (2–5 years old) and another for older children (5–12 years old). Miracle Park is one of the top outdoor playgrounds in the Midwest. Miracle Park also includes three shelter houses, concrete basketball courts, and a granite Veterans Memorial.





Trains & Toys

Come to Life

at Butler County attraction

CLARKSVILLE — Butler County was once a bustling hub of railroad activity, hosting multiple main lines running through the central and southern portions of the county.

The history of railroading in the area and beyond is preserved at an attraction just outside Clarksville. Trains on the Farm features a unique look at railroading in an agricultural setting while also having exhibits on toys from a bygone era.

"This is my hobby," Trains of the Farm owner Frances Edeker said. "I've been doing it for years, and people finally said, 'You need to open this up to the public.'"

Trains on the Farm opened in 2017. It features six buildings full of model train layouts and toys that go along with them. All told, the attraction features 10 different layouts in scales ranging from N-gauge all the way up to G-scale and beyond. Each of the layouts depicts a part of northeast Iowa railroading history.

"I go back about 150 years and I go through time showing different things of what the railroad has done, all the way from the Civil War up to now," Edeker said. "It's the general history of railroading, plus history from northeast Iowa."

There is also a 67-foot map depicting the Rock Island Railway, which is now operated by the Iowa Northern Railroad.

Edeker said he became interested in trains while growing up on a farm north of Clarksville where the railroad cut through the property. That, he said, was when he began collecting railroad memorabilia. Edeker also worked on the Iowa Northern.

Of all his layouts, he said one in his basement consisting of Marx toys is one that stands out.

"In the 1950s and 60s, Marx was the

largest toy company in the world," he said. "They made a lot of different toys over the years and they made play sets. If there was something going on in the world, they made a play set for it and usually there was a metal building with it. It might be Cape Canaveral, it might be a circus, it might be the Robin Hood, whatever was going on. And in my basement, I have 30 of those on display with all the Marx trains."

Another layout Edeker pointed out was in the machine shed on his farm.

"It's a train set that was given to me by a family from Des Moines," he said. "They said their father got Alzheimer's and he wanted (the layout) to go to somebody, have it to run for kids. It's O-Scale and I have a big layout in my machine shed with that. That's great to be to show the kids that."

Since opening Trains on the Farm, Edeker said he continues working on the layouts. He is currently working on two that he hopes to finish this spring.

One of the layouts had been run by the former Iowa State University Model Railroad Club at a shopping mall in Ames. When the club disbanded, it left the layout.

"They were going to throw it away if someone didn't want it," Edeker said.

"All they wanted was someone to pick it up and haul it out of there. So I inherited the Iowa State Model Railroad Club, a lot of their buildings, tracks and landscape materials and stuff."

"I'm always working on something because somebody's giving me something," he said. "That's what's happened over the last few years."

It is not just trains that people have given Edeker. He said he has 22 dollhouses on display including several that were given to him after visitors saw the others.

"People see the dollhouses and say, 'Oh I have a dollhouse in the attic.' They

just want it where people can see it."

Each of the toys is fit to a railroad layout where its scale matches the scale. Edeker said one of his buildings is filled with five generations of farm toys around a train layout build around farming.

Each of the layout has its own unique features and each has at least one farm on it. One features a cardboard farm from the 1930s where every building, animal, etc. is made of cardboard. Another was sold by Montgomery Ward's in the 1940s and features buildings and hard rubber animals. The 1950s farm features metal buildings, plastic fence and soft rubber animals.

Another display features 35 years of history from Operation Lifesaver, an organization dedicated to safety around railroad crossings.

Edeker said attendance at the attraction started strong before falling off sharply during the pandemic. He said it has picked up since, with 2024 the best year that he has had.

"We've had a lot of groups come through this year," he said.

Visitors have come from several different states as well as Brazil and China. Edeker said it generally takes about 2 ½ hours to tour the attraction, though he has had people there for five hours or longer.

"I have a lot of railroad history, pictures and maps and stuff, that a lot of people don't usually see," he said. "I have researched a lot of northeast Iowa and I have about 150 rural signs. I have all the Rock Island (Railway) signs that they had on the road, except two."

Trains on the Farm is open year-round by appointment. To schedule a tour, contact Edeker at 319-415-4814.

Worship in Butler County



ST. JOHN'S EVANGELICAL
LUTHERAN CHURCH—VILMAR NALC

ACKLEY
Washington Reformed Church
28182 Birch Avenue • (641) 847-2817

ALLISON
Bible Church
108 Pfaltzgraff Street • (319) 267-2455

Congregational Church
508 N. Main Street • (319) 267-2333

St. James Lutheran Church
421 N. Main Street • (319) 267-2274

Trinity Reformed Church
614 Cherry Street • (319) 267-2982

APLINGTON
First Reformed Church
905 Caldwell Street • (319) 347-2444

Aplington Baptist Church
1003 Nash Street • (319) 347-2311

Hitesville Gospel Hall
17527 260th Street

AREDALE AND DUMONT
New Hope Parish
United Methodist Churches
706 Locust St, Dumont IA 50625
(641) 857-3753

BRISTOW
Church of Christ
822 West St, Bristow, IA 50611
(641) 775-3222

First Reformed Church
916 Center St, Bristow, IA 50611
515) 532-2274

CLARKSVILLE
Community United
Methodist Church
309 W. Superior Street (641) 816-4256

Church of Christ
302 S. Elizabeth Street
(319) 278-4416

Immanuel United
Church of Christ
203 S. Mather Street • (319) 278-4224

St. John Lutheran Church
204 N. Washington • (319) 278-4765

DUMONT
Reformed Church
912 3rd St, Dumont, IA 50625
(641) 857-3514

GREENE
First Presbyterian Church
319 East Traer Street • (641) 816-4435

St. Mary's Catholic Church
105 N. Main Street • (641) 823-4146

St. Peter Lutheran Church
324 E. Traer Street • (641) 816-5531

Calvary Baptist Church
312 S. Main Street • (641) 257-8148

NEW HARTFORD
New Hartford Community
Church
406 Onieda Street • (319) 983-2322

PARKERSBURG
Bethel Lutheran Church
701 Third Avenue • (319) 346-2028

United Methodist Church
502 Florence St, Parkersburg, IA 50665
(319) 346-1076

Faith Lutheran Church
608 Sixth Street • (319) 346-1451

First Congregational Church
401 Third Street • (319) 346-1373

PLEASANT VALLEY
First United Church of Christ
31015 150th Street, Clarksville, IA
50619 • (319) 276-4443

SHELL ROCK
United Methodist Church
204 S. Prairie Street • (319) 885-4554

Peace Lutheran
Church (LCMS)
121 East Washington • (319) 231-9761

Faith Lutheran Church
422 N. Prairie Street • (319) 885-4547

VILMAR
St. John's Evangelical
Lutheran Church—Vilmar NALC
16073 Keystone Avenue, Greene
(319) 267-2080

**YOUR ONE
STOP SHOP**
FOR ALL YOUR HARDWARE
& GARDEN NEEDS

WE CARRY

DEWALT **Milwaukee**
STANLEY **BOSTITCH**
DIABLO **valspar**

**PARKERSBURG
HARDWARE
& GARDEN
CENTER**

OPEN
MON- FRI 8-6 PM
SAT- 8-5 PM
SUN- NOON-5 PM

504 HWY. 57
PARKERSBURG
319-346-1722

PARKERSBURGHARDWARE.COM

Welcome to Clarksville!

Our *Top 5 Tips* for healthy travel:

- 1 Use sunscreen and insect repellent.
- 2 Get plenty of rest.
- 3 Wash your hands often.
- 4 Drink enough fluids.
- 5 Bring along a travel medical kit.

If you need medical or dental care during your visit, give us a call!

 **PEOPLES**
Clinic Butler County

319.278.9020
118 South Main Street
Clarksville
www.peoples-clinic.com

Fun Retro Shopping!

- ♦ Household Decor
- ♦ Vintage Electronics
- ♦ Kitchen And Glassware
- ♦ Barware
- ♦ Vinyl Records

And More from the 1950's to 1970's.

We are an occasional store open select weekends and by appointment.

Follow us on Facebook to get advance notice of our open dates and to view pictures.

**This & That
VINTAGE**

308 North Main St.
Downtown Allison
(319) 239-0633

 Like us on Facebook

WOODLEY FUNERAL HOME AND CREMATORY

Serving with Reverence and Distinction

Hampton - Woodley Funeral Home 306 Central Ave. East, Hampton, IA 50441 (641) 456-3232	Allison - Woodley Funeral Home 308 Birch Street, Allison, IA 50602 (319) 267-2507
Iowa Falls - Woodley Funeral Home 516 S. Oak Street, Iowa Falls, IA 50126 (641) 648-7700	Dumont - Woodley Funeral Home 902 West Broadway Street, Dumont, IA 50625 (641) 857-3303
Greene - Woodley Funeral Home 519 N. 1st St., Greene, IA 50636 (641) 823-4457	Thornton - Woodley Funeral Home 107 N 2nd St, Thornton, IA 50479 (641) 998-2311

Also serving Latimer (641-456-3232), Sheffield (641-892-4241), and surrounding communities.

TRAINS FARM

Visit Trains on the Farm

FOR ALL AGES: Come on a 2 hour tour of the Iowa Northern Railway / Rock Island and other Railroads displayed in the buildings on the farm.

For more information on visiting Trains on the Farm or scheduling a tour contact: Francis L. Edeker
319-278-4847 OR 319-415-4814
30215 170th St., Clarksville, IA 50619 fcdeker@butler-bremer.com

Explore the history of Iowa railroading, farming and more. Exhibits include maps and dioramas of the Rock Island and Iowa Northern Railroads, farm equipment tools and supplies, model and toy trains of all gauges, Disney items, movie and TV displays and much, much more.

Butler County *Conservation Areas*

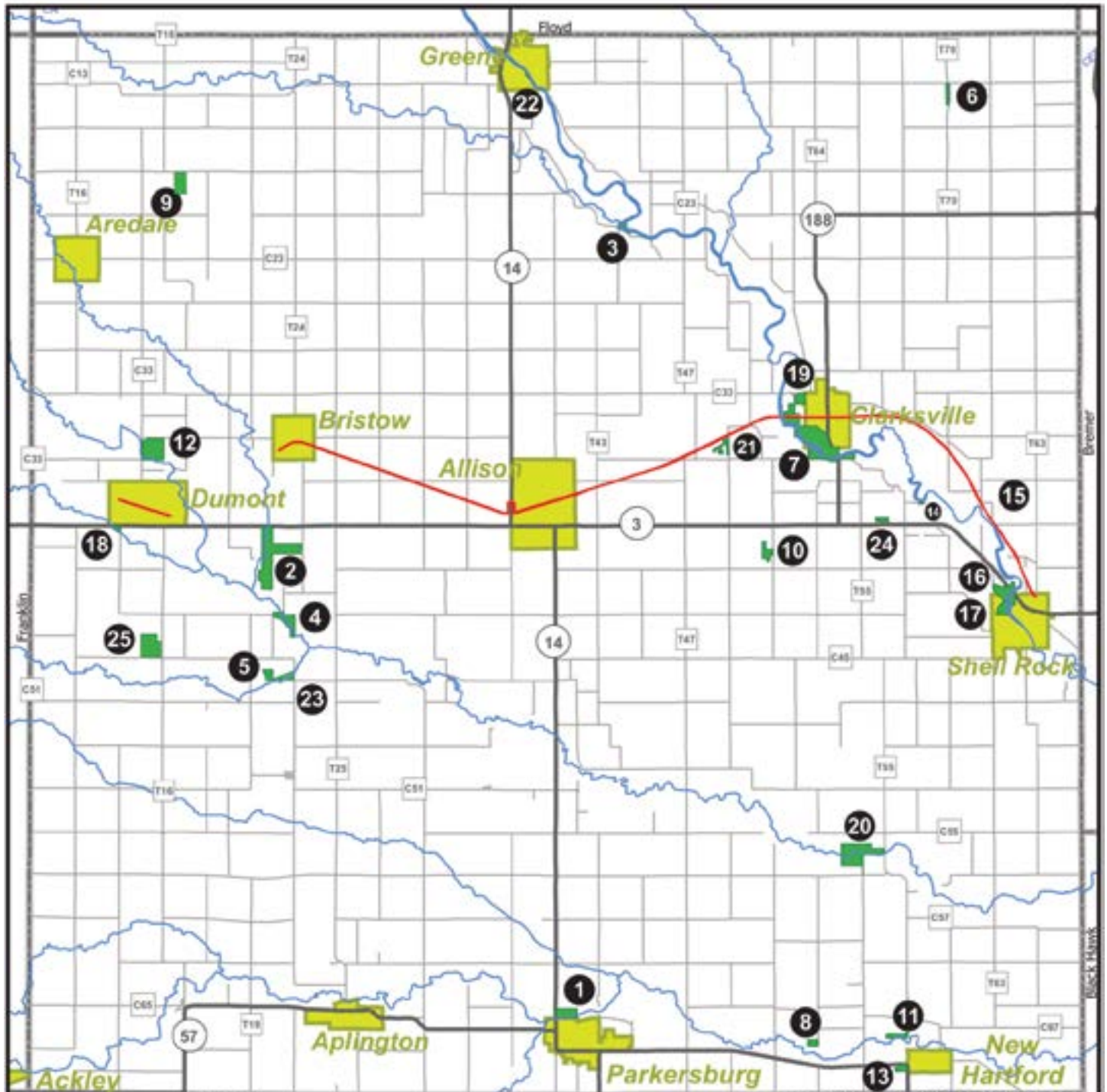

Butler County

		ACREAGE	CAMPUSSES: Electric Full Hookup/No Electric Equine/Youth Dump Station/WIFI	WATER Drinking Showers	TOILETS	CABIN RENTAL	SHELTER: Seasonal Year Round	PICKICKING	TRAILS: Blue Hard Surface/Limestone/Equine/Hiking/Snowmobile/ATV, Ski-Groomed	SWIMMING	FISHING: Jelly/Pier/Lake/Juvenile	BOATING: Canoe/Kayak/Swim or River/Traut	SPORTS: Archery/Baseball/Disk Golf/Golf/Horsehoe for Skating/Pangloss/Target Shooting/Range/Bleeding	SITES: Amphitheater/Auditorium/Bird Watching/Wildlife Exhibit/Historic Site/Nature Center
1. Beaver Meadows Park 32078 Hwy. 14, N edge of Parkersburg	32	E18, N10	D, S*	A		OF2	P			S	C	G, P, D	B, Wo	
2. Boylan Creek Wildlife Area 1504 Hwy. 3, Bristow	309							H, E					P, B, Wo	W, F, U
3. Camp Comfort 23525 Camp Comfort Rd., 4 mi. SE Greene	20	E19, N10	D	F		OF1	P			S	M, C, R	P	B, Wo	
4. Considine Lake 1550 230th St., Bristow	90						P			L20, S	C, E		B, Wo	F
5. Faber Memorial Preserve 24260 Forest Ave., 6 mi. S of Bristow	28												W, P, B	
6. Hauser Wildlife Area 11611 Val Ave., 8 mi. E of Greene	25												P, B	
7. Heery Woods State Park 19195 Hwy. 186, Clarksville	380	E20, N15, Eq	D, S*	F*		ER1*, OF2*	P	H3, E2, B1, X3, S		S	M, C, R	P	N, E, P, B, Wo	
8. Helt Memorial Preserve 32817 Spring Ave., 3 mi. NW of New Hartford	25												P, B	U
9. Kyle Wildlife Area 13286 130th St., Greene	79												B	
10. Leeper Prairie Preserve 21657 Ridge Ave., Clarksville	41												P, B	
11. Moore's Access 29988 Trapper Rd., 2 mi. NW of New Hartford	35									S			B, Wo	F
12. North Butler Wilderness Area 1 mi. N of Dumont	227												P, B	F, U
13. Paul Schoeman Nature Area 29752 Hwy. 57, New Hartford	27												W, P, B	
14. Renning's Landing 30207 205th St., Shell Rock	2									S	M, C, R			
15. Rolling Prairie Trail 15 mi. trail N edge of Shell Rock to E edge of Allison	347						P	H15, B15, X					P, B, Wo	
16. Shell Rock Park 22562 Willow Ave., Shell Rock	67	E27, N15	D, S*	F*, V		OF1	P			P*, L3, S	M, C, R	P, H	B, Wo	
17. Shell Rock Wildlife Area NW edge of Shell Rock	51									S			W, B*, Wo	
18. South Fork Park 21045 Cedar Ave., 1 mi. W of Dumont	10									J, L4, S	C, E			W
19. Sportsman's Park 27588 180th St., Clarksville	36	N5		V		OF1	P			P*, L8	C, E			
20. West Fork Forest Access 28376 Temple Ave., New Hartford	204									S	C		B, Wo	W, F, U
21. Wolters Prairie Preserve 19155 Quail Ave. 3 mi. SW of Clarksville	44												P15	
22. Wunsch Memorial Park 201 S. Water St., Greene	4	E10, N5	D	F		OF1	P			S	M, C, R	P		
23. Lucky Seven Preserve Grand Ave., 6 mi. S of Bristow	41												W, B	
24. Hogenkamp Wildlife Area Hwy. 3, Clarksville	36												P, B, W	W, U
25. Eisenberger Wildlife Area 2 mi. South of Dumont	116												W, P, B	W, U

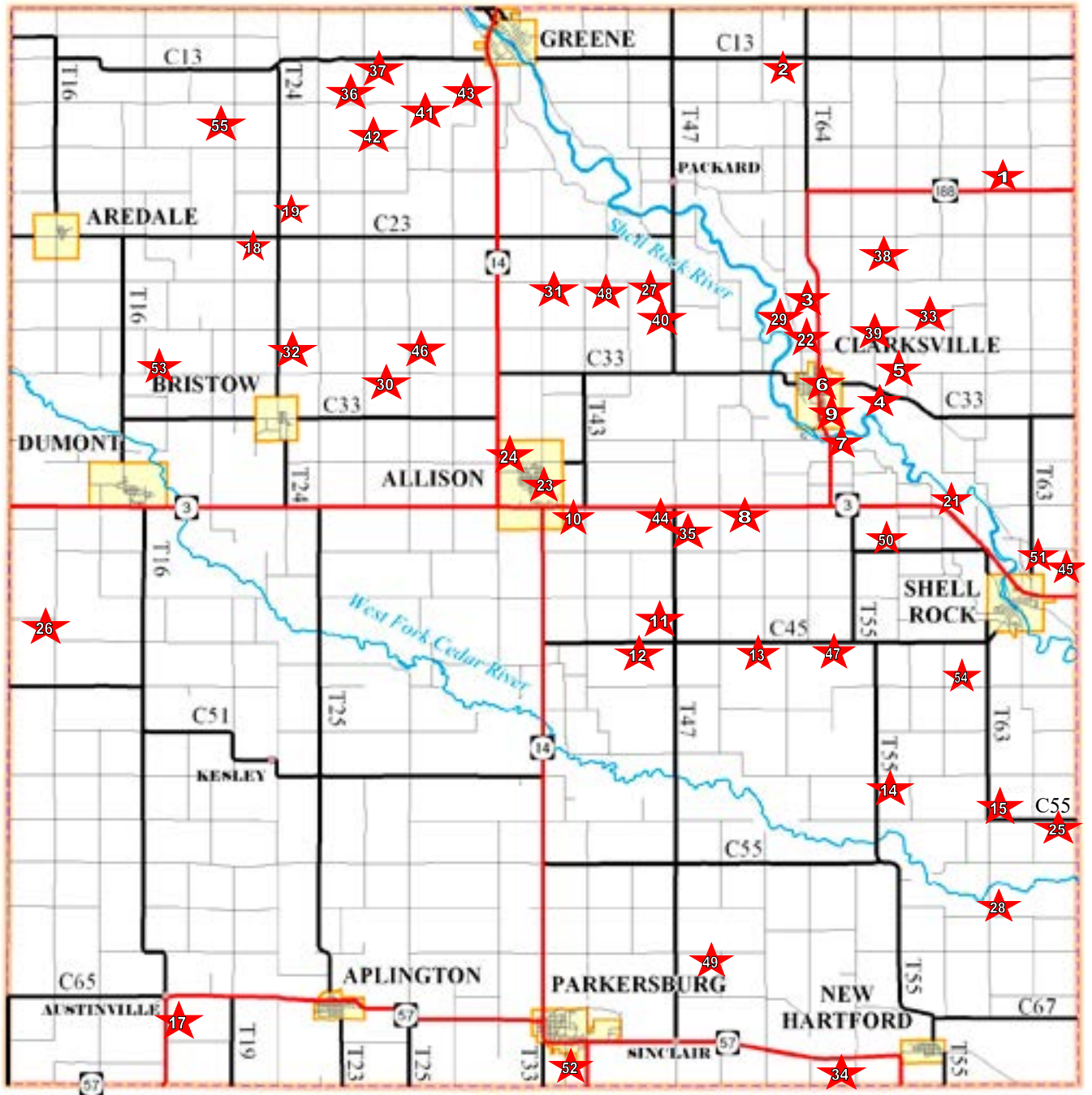

Map Number	Address of Barn	City	Owner Name	Quilt Pattern Name
1	33131 Highway 188	Clarksville	Nathan Chester	"Saw Tooth Star & Nine Patch in Middle"
2	27382 110th St (C13)	Greene	Andrew and Marcella Nixt	"LeMoyne Star"
3	16991 Hwy 188	Clarksville	Mary Freese	"Rail Fence"
4	29361 Superior Rd (C33)	Clarksville	Stauffer Family	"Basket of Lilies"
5	17957 Upland Ave	Clarksville	Brandon and Catherine Kramer	"Bear Paw"
6	208 North Main St. (downtown)	Clarksville	Clarksville Lumber	"Fox and Geese"
7	19782 Hwy 188	Clarksville	Paul and Lucille Leerhoff	"Ohio Star"
8	26482 Highway 3	Clarksville	Di and Randy Miller	"Five Point Star"
9	1100 South Mather St.	Clarksville	City Park Shelter	"Water Wheel"
10	22352 Highway 3	Allison	Cody Wangness	"Starlight Variation"
11	23685 Sinclair Ave (T47)	Allison	Edward Johnson	"Flying Squares"
12	24904 Butler Center Rd (C45)	Allison	Darin Stokes	"Corn and Beans"
13	27924 Butler Center Rd (C45)	Clarksville	Monica Lursen	"Cyclone"
14	29556 270th St	Shell Rock	Dave Albrecht	"Goose in the Pond"
15	32461 280th St	Shell Rock	Fred and Judith Strotman	"Schoolhouse"
16	This quilt removed			
17	32696 Hwy 57	Aplington	Carolyn Hartema	"Sunflowers"
18	15406 150th St	Bristow	Jeanette and Bruce Miller	"Eight Pointed Star"
19	14346 Grand Ave (T24)	Bristow	Ed and Luella Miller	"Iowa Star"
20	This quilt removed			
21	31121 Highway 3	Shell Rock	Norm and Jan Mulder	"Flying Dutchmen"
22	17535 Hwy 188	Clarksville	Betty Miller	"Gold Rush"
23	101 South Main St. (fairgrounds)	Allison	Butler County 4-H	"County Fair"
24	1006 7th Street (in city - west side)	Allison	Allison Farmer's Feed & Grain	"Harvest Star"
25	33714 280th St (C55)	Shell Rock	Dorothy Schwab	"Green Boutonniers"
26	23813 Birch Ave	Dumont	Ray & Betty Wickham	"Ohio Star 4x4"
27	24616 160th St	Greene	Wesley Ruby	"Stars & Diamonds"
28	32063 302nd St	New Hartford	Liz Rittgers	"Eight Hands Around"
29	17021 Royal Ave	Clarksville	Carolyn Bohner	"Pot of Flowers"
30	18328 180th St	Bristow	Beryl & Shirley Wubbena	"Stained Glass"
31	16054 Marsh Ave	Allison	Gladys Wubbena	"Eight pointed star"
32	17302 Grand Ave (T24)	Bristow	Arlin & Greta Eberline	"Freedom"
33	30215 170th St	Clarksville	Francis & Carol Edeker	"Double Aster"
34	33785 Terrace Ave	New Hartford	Vopal Youngberg	"Old Glory Star"
35	21338 Sinclair Ave	Allison	Eric & Vikki Bixby	"Martha Washington Star"
36	17813 120th St	Greene	Richard & Mary Ann Vickers	"Variation on Ohio Star"
37	18262 110th St	Greene	Graydon & Bernita Anderson	"Star Variation"
38	15657 Union Ave	Clarksville	Tom & Paula Barnett	"American Flag Variation"
39	29673 175th St.	Clarksville	Lynn & Rocky Norton	"Delectable Mountain"
40	16975 Packard Ave	Clarksville	Lucas & Alesha Wedeking	"8 Point Star Variation"
41	19456 120th St.	Greene	Doug Marsh	"Memories Never Fade"
42	12784 Ivy Ave.	Greene	Joseph & Kristin Becker	"Star of David"
43	11953 Kipling Ave.	Greene	Nathan Siemons	"Carpenter's Wheel"
44	21121 Sinclair Ave.	Allison	Dan & Amy Homeister	"Kentucky Chain"
45	22327 Butler Ave.	Shell Rock	Dave & Marion Epley	"Whirlwind"
46	17542 Jay Ave.	Bristow	Ken & Margaret Debower	"LeMoyne Star"
47	28632 Butler Center Rd (C45)	Shell Rock	Patrick & Kim Lursen	"Go State"
48	23592 160th St.	Greene	Barb Wagner	"Center Stage"
49	25898 310th St.	Parkersburg	Kevin & Jill Toben	"Sister's Choice"
50	29727 220th St.	Shell Rock	Jack & Mari Kramer	"Daisy Basket"
51	22494 Yale Ave.	Shell Rock	Epley Bros. Hybrids, Inc.	Company Logo
52	33616 Martin Ave.	Parkersburg	Stan & Vickie Thompson	"A Missouri Star"
53	18239 Dodge Ave.	Dumont	Dwight & Leslie Haverkamp	"IH Farmall Custom Design"
54	31719 250th Street	Shell Rock	Burdette & Elyn Johnson	"Ohio Star with a brand 'Rafter J'"
55	12383 Forest Ave.	Bristow	Marie Heeren	"Compass Star"

January 2024

Butler County *Snow Snoops*

SNOWMOBILE TRAIL MAP

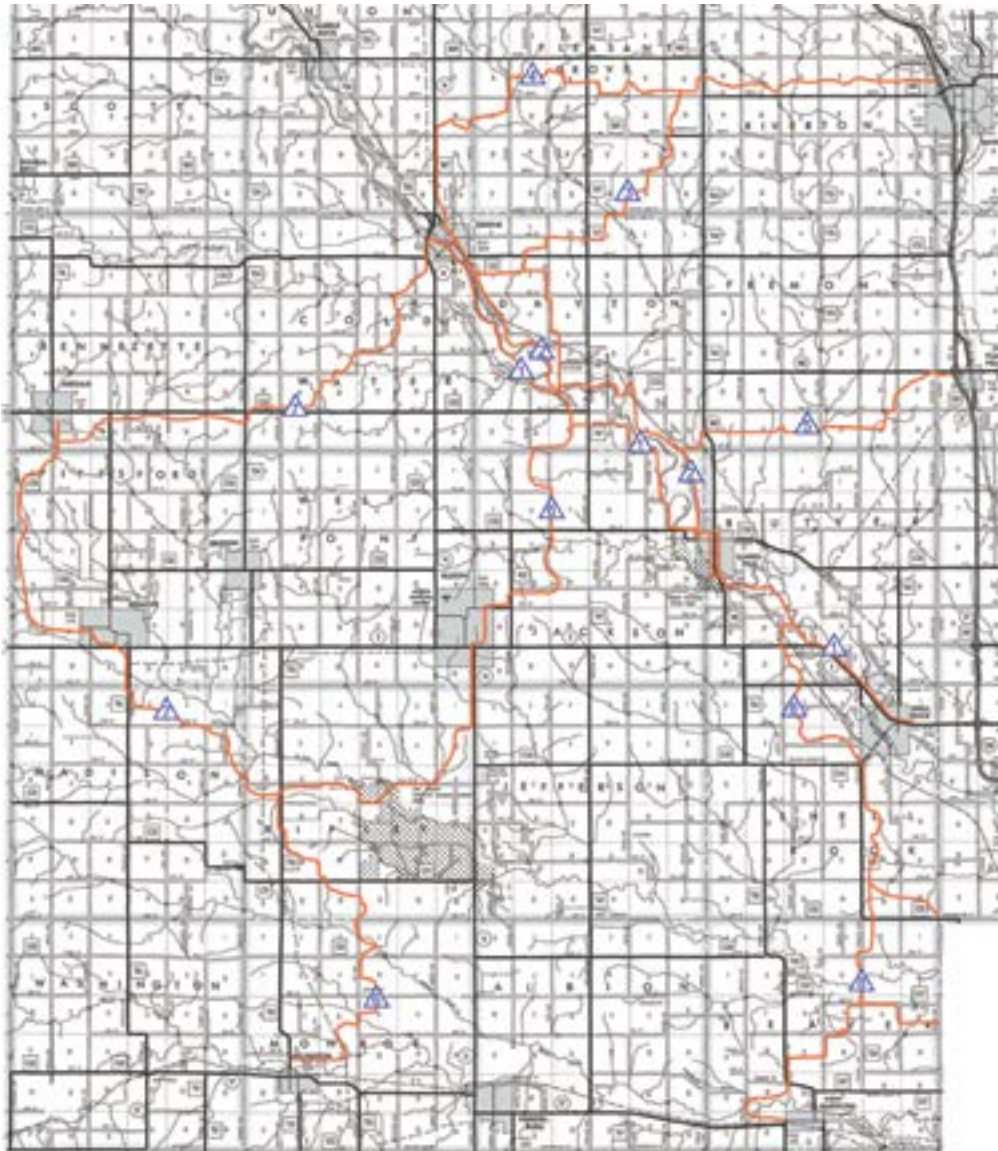

The Butler County Snow Snoops offer well groomed snow covered trails, fun, family oriented activities, and much more. Club rides are held locally as well as out of state, and meetings are held the first Wednesday of each month at area businesses. There are even canoe floats in the summer!

Interested riders do not have to live in Butler County to be a member. In fact, this club has members from several counties and many of them belong to more than one club in the area. Membership is \$25/single and \$30/family per year. This includes membership to the Iowa State Snowmobile Association.

If you are a snowmobile enthusiast, belonging to a snowmobile club is important. It's these clubs that line up, clear, mark and groom the trails for everyone to enjoy. Membership is key to keep funding coming in to the clubs to pay for grooming costs. If you would like to become a member of the Butler County Snow Snoops you can email: snowsnoops@butler-bremer.com.



ALL 3 LOCATIONS ARE LOCATED ON ONE BLOCK! Visit us online: clarksvilleskillednursing.com



Clarkville

Skilled Nursing & Rehabilitation Center



115 N. Hilton St., Clarksville, IA • (319) 278-4900 • Fax (319) 278-4166

- Skilled Nursing, Physical, Occupational, and Speech Therapy
- Private and Shared Room Accommodations
- Home Delivered Meals
- Maintains Above Average Staff to Resident Ratio
- Purposeful activities. Join the "We Care the Do Gooder's Club"



WESTSIDE
ASSISTED LIVING SUITES

110 N Ely, Clarksville, IA

(319) 278-4909 • Fax: (319)-278-4903

- Promoting independence while giving families peace of mind
- Three squared meals a day at no additional cost!
- Tenant Directed Services
- Offering comfortable and affordable living accommodations – studio, one and two bedroom options. Apartment sizes range from 479 sq. ft. up to 906 sq. ft.

Community Retirement Village

- Independent Living Complex
- USDA Subsidized (rental assistance)
- Elderly & Disabled housing on one block
- 1 & 2 Bedroom Apartments. 600+ sq. ft.
- Maintenance Free
- On-going refurbishing of apartments
- Meal Delivery Services*
- Social Room to Accommodate Large Gatherings (319) 278-4900

*=additional charge

For more information on all 3 living accommodations, visit:

www.clarksvilleskillednursing.com



Scan The Code



Doug's Heating & Cooling



CLIMATEMASTER

- Heating
- Geothermal
- Air Conditioning
- Plumbing
- Sewer Cleaning



Doug • Garrett
Lance • Ethan • Pat

402 W. Weare
Clarksville, Iowa
319-278-4493

Black Sheep Cafe

Where *community* is valued,
great coffee and good food are enjoyed,
and every aspect of life is respected.



Fresh Bread & Baked Goods
Everyday!
Light Breakfast & Lunch Daily
Online Ordering
Watch our website & FB for PopUp
Evening Café



115 E Traer St. • Greene, IA
641-816-3102
theblacksheepcoffeebaa.com

Mon. – Fri. 6am-2pm
Sat. 7am-1pm
Thurs. pm 4-7

WILDER PARK

"Our Secret is Out... North Central Iowa's Most Unique Recreation Area"



**Full Season Campsites When Available!!
Dog Park!**

**Open year round
Overnight Stays - Special Events**

For rental availability see: visitwilderpark.com
or email: callison@netins.net for more information.



Amenities include: Camp Host, Lodge, Rental Cabins, Limited Wi-Fi, 52 spacious campsites with 40 full hook-ups, Tent Camping Sites, Two Fishing Ponds, Two Shelter Houses, 18 hole Disc Golf, Miniature Golf, Butterfly Garden, Walking/Biking Trail connected to Rolling Prairie Trail, 2 Playgrounds, Pickleball, Shower House, Severe Weather Shelter, Wild Flower Prairie ...All in a Tranquil Setting.



GREEN BELT
BANK & TRUST
www.greenbeltbank.com

Team Green Parkersburg Branch

604 Hwy 57, Parkersburg, IA • 319.346.8144

Stop in to visit with our staff for all of your financial needs.



Member FDIC
Equal Housing Lender